

**Boardwalk**

# Savoy Court

BRISLINGTON

APPROXIMATE FLOOR AREA  
47 SQM / 506 SQFT

BOOK A VIEWING  
01174 532 985  
[hello@boardwalkpropertyco.com](mailto:hello@boardwalkpropertyco.com)

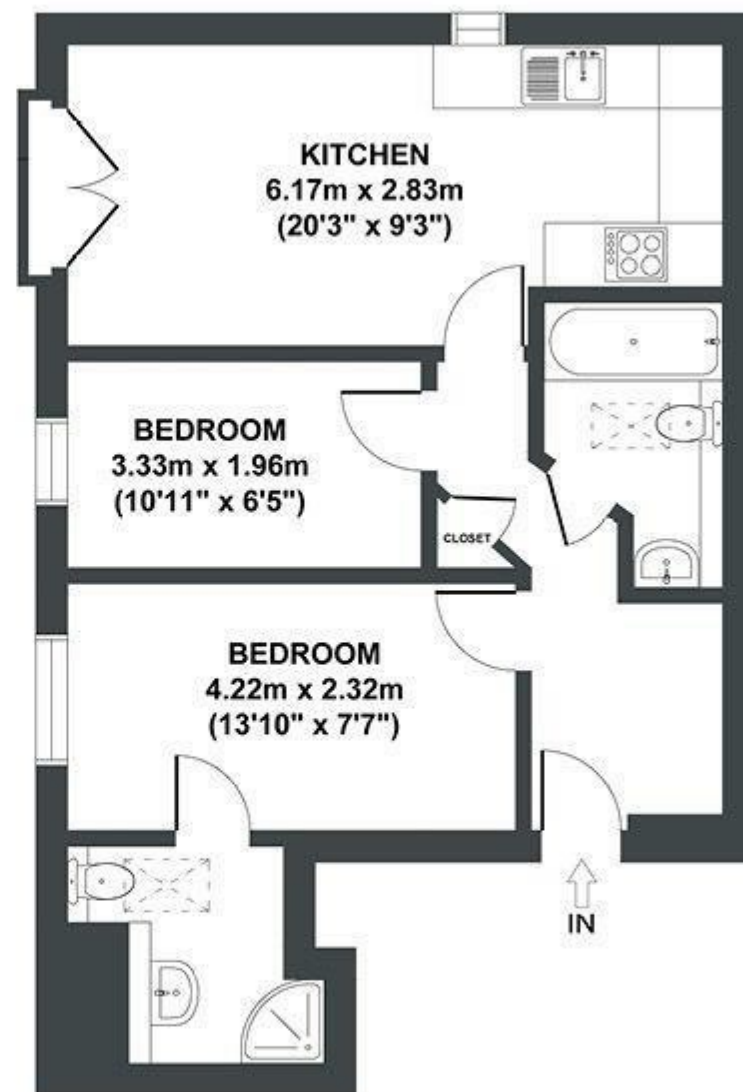

Illustrations are for reference purposes only, measurements are approximate, not to scale.

Boardwalk

# Savoy Road , BRISTOL



£215,000



2 Bedrooms



Bristol, BS4



2 Bathrooms

3SX

*"This flat was an excellent first step on the property ladder. It provided significant additional space and natural light, from both sides of the property, than our previous home. We liked the partially sloped ceilings and winding corridor that added character without being obstructive. It boasts a variety of lovely close-by nature spots, including Conham River Park, the Bristol to Bath cycle path, Amos Court Park, Trooper's Hill, and Eastwood Farm Nature Reserve. It's also commutable to the city centre, Bath, and Chepstow, and has enough space for us to work from home. The proximity to Sandy Park, Sainsbury's, and Avonmeads retail park (Lidl, M&S Food, The Gym, McDonald's, Showcase Cinema...) complex were also perks. The underfloor heating seemed efficient as we always stayed warm and didn't notice a significant difference between summer and winter energy costs."*

